

## Water Pump: Service and Repair Component

### WATER PUMP

#### Component

SEC. 210-211

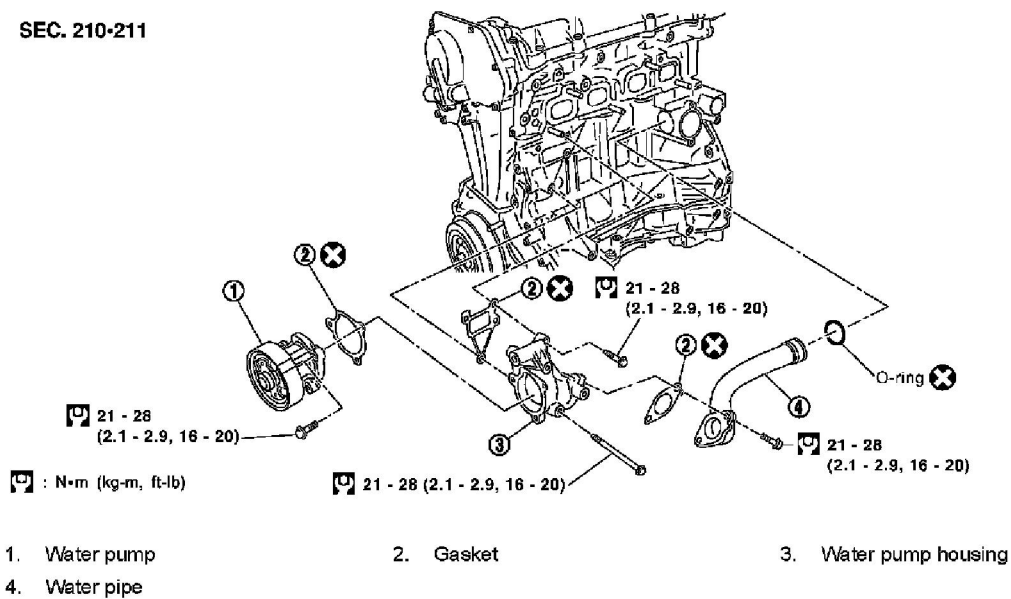

## Water Pump: Service and Repair Removal and Installation

### WATER PUMP

#### Removal and Installation

##### **WARNING:**

**Never remove the radiator cap when the engine is hot. Serious burns could occur from high pressure engine coolant escaping from the radiator.**

##### **REMOVAL**

1. Drain engine coolant from the radiator. See: Cooling System/Coolant/Service and Repair/Changing Engine Coolant.

##### **CAUTION:**

**Perform this step when the engine is cold.**

2. Remove RH wheel and tire assembly. See: Maintenance/Wheels and Tires/Service and Repair/Adjustment.
3. Remove the front air duct. See: Tune-up and Engine Performance Checks/Air Cleaner Housing/Service and Repair.
4. Remove the generator. See: Starting and Charging/Charging System/Alternator/Service and Repair.
5. Remove engine ground strap.
6. Remove the water pump.

##### **NOTE:**

If necessary, the exhaust manifold catalytic convertor assembly must be removed to remove the water pipe.

##### **CAUTION:**

- **Handle the water pump vane so that it does not contact any other parts.**
- **Water pump cannot be disassembled and should be replaced as an assembly.**

#### INSPECTION AFTER REMOVAL

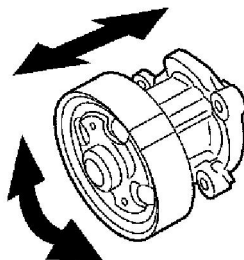

- Visually check that there is no significant dirt or rusting on the water pump body and vane.
- Make sure that there is no looseness in the vane shaft, and that it turns smoothly when rotated by hand.
- Replace the water pump, if necessary.

#### INSTALLATION

- Installation is in the reverse order of removal.
- When inserting water pipe end to cylinder block, apply a neutral detergent to O-ring. Then insert it immediately.

#### INSPECTION AFTER INSTALLATION

- Check for leaks of engine coolant. See: Cooling System/Coolant/Service and Repair/Inspection.
- Start and warm up the engine. Visually check for leaks of engine coolant.